

*Keystone Christian
Education Association*



46th Annual Christian Education Conference

September 26-27, 2019

*DoubleTree by Hilton Resort / Willow Valley
Lancaster, PA*

Conference Floor Plan

DoubleTree Resort at Willow Valley

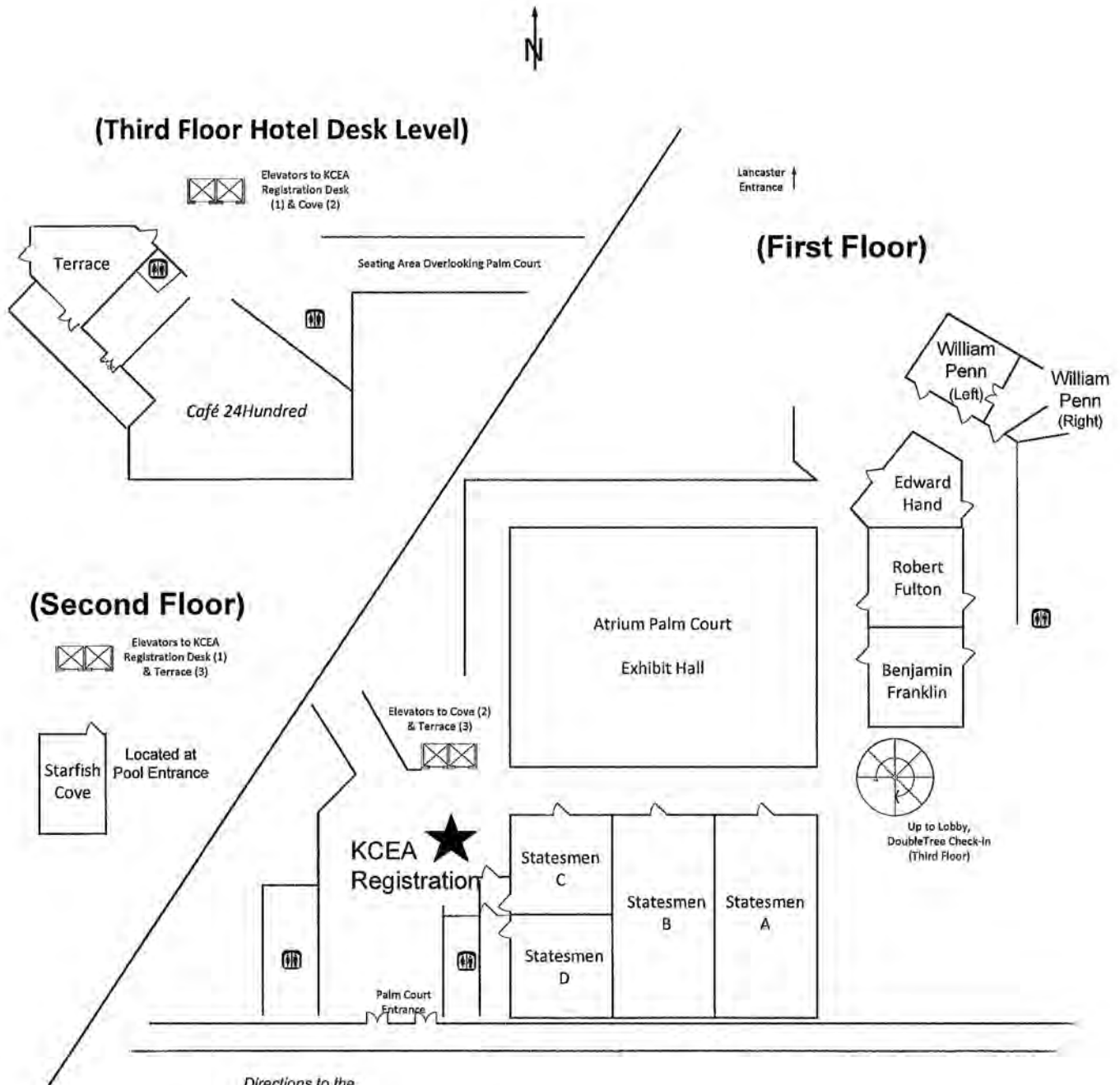

Directions to the Wedding Chapel:

Use the entrance beside KCEA's Registration Desk. Cross the street and follow the walking path at the right of the pond.

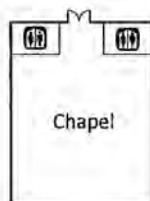

Welcome!

to KCEA's 46th Annual Conference



In 2 Thessalonians 3, the reader discovers that a segment of the church creates tension within the body by living in idleness. Paul's response is severe, urging the dependable members of the church to "withdraw" from the parasitic brethren. Yet, like so many of us learn to do in our ministries, Paul turns the negative admonition into a positive appeal. Motivated by personal concern for the Thessalonian believers, Paul takes the opportunity for a moment of "professional development."

The theme verse for this year's Conference reminds us that teaching occurs by admonition AND by example. Paul reminds his readers that he had suspended his own rights while with the Thessalonian believers, not because he lacked authority, but "to make ourselves an ensample unto you to **follow us.**"

We have two days ahead of us – days filled with instruction, challenge, and encouragement. You have the opportunity to choose multiple workshops whose leaders are not just college-taught but are field-proven, who by teaching from experience can provide you with additional tools for you and your ministry. More importantly, over the course of the 2019-2020 school year YOU will be setting the example for those to whom you will be ministering. Like Paul, may you be motivated by personal concern for each individual as you aim to disciple.

If there is anything we on KCEA's Board or staff can do to help you while you are here, please come to us. Just look for our blue name badges. We are here to serve you.

Welcome.

Dr. Allen Harris
KCEA President

Your Conference Schedule

THEME: "...Follow us" (II Thess. 3:9)

THURSDAY

8:45—9:35	Workshop 1
9:45—11:30	Opening Assembly Offering Staff Recognition Education Address – Dr. Russell Shelley Main Address – Missionary Donald Kilmer
11:30	Exhibits Open (Palm Court)
11:30—12:40	Lunch A (Café 24 Hundred)
11:45—12:35	Workshop 2
12:35—1:45	Lunch B (Café 24 Hundred)
12:50—1:40	Workshop 3
2:00—2:50	Workshop 4
3:15—4:05	Workshop 5
4:30—5:20	Workshop 6
6:00	Exhibits Close (Palm Court)
6:00	Dinner

Between 11:30 and 2:00, each delegate can choose to (1) attend up to two workshops (quickly grabbing a snack), (2) include a full lunch break, (3) invest time in the Exhibit Hall, and/or (4) accomplish other priorities.

FRIDAY

7:30—7:50	Prayer Time (Ben Franklin / Robert Fulton)
8:00	Exhibits Open (Palm Court)
8:00—8:50	Workshop 7
9:15—10:05	Workshop 8
10:30—11:20	Workshop 9
11:30—12:40	Lunch C (Café 24 Hundred)
11:45—12:35	Workshop 10
12:35—1:45	Lunch D (Café 24 Hundred)
12:50—1:40	Workshop 11
2:00	Exhibits Close
2:00—3:45	Mid-day Assembly Offering Staff Recognition Education Address – Dr. Roger Bradley Main Address – Dr. Alton Beal
3:55—4:45	Workshop 12
4:45	Dismissal

Between 11:30 and 2:00, each delegate can choose to (1) attend up to two workshops (quickly grabbing a snack), (2) include a full lunch break, (3) invest time in the Exhibit Hall, and/or (4) accomplish other priorities.

Workshop Leaders

Timothy Anger	Principal, Emmaus Baptist Academy, Emmaus
Sara Atwood	County Director, Child Evangelism Fellowship of Eastern PA, Harrisburg
J. Andrew Barclay	Accountant, Flowers & Flowers CPAs, Harrisburg
Dr. Mary Barclay	Adjunct Professor and KCEA Staff, Harrisburg
Dr. Alton Beal	President, Ambassador Baptist College, Lattimore, NC
Dr. Roger Bradley	Professor, Bob Jones University, Greenville, SC
Eric Bryant	Professor and Department Chair, Pensacola Christian College, Pensacola, FL
Joy Budensiek	Author and Professor, Hobe Sound Bible College, Hobe Sound, FL
Ann Carruthers	Teacher, Bob Jones Academy, Greenville, SC
Dr. Brian Carruthers	Professor and Department Chair, Bob Jones University, Greenville, SC
Shawntel Chisholm	Writer, BJU Press, Greenville, SC
Michael Clater	Librarian and Manager, Dauphin County Library, and KCEA Staff, Harrisburg
Phillip Contompasis	Assessment Consultant, Riverside Assessment/Iowa Testing, Schenectady, NY
Susan Crago	Teacher, Carroll Christian Schools, Westminster, MD
Dana Davis	Professor, Maranatha Baptist University, Watertown, WI
Dr. Jeff Davis	Dir. of Development, Child Evangelism Fellowship of Eastern PA, Harrisburg
Bob Eble	Teacher, Canaan Christian Academy, Lake Ariel
Christal Edwards	Teacher, Canaan Christian Academy, Lake Ariel
Brooke Greening	Elementary Principal, Pensacola Christian Academy, Pensacola, FL
Karen Harris	Lead Teacher, Hope Christian School, Hanover
Dr. Hubert Hartzler	Education Consultant, Christian School Leadership Ministries, Piscataway, NJ
Donald Kilmer	Missionary, South Africa
Carris Kocher	Committee Chair, Bill of Rights Bicentennial Committee, Concordville
Pam Litzenberger	Writer, BJU Press, Greenville, SC
Dee Long	Professor, Faith Baptist Bible College, Ankeny, IA
Cindy Quinlan	Consultant, Abeka, Pensacola, FL
Dr. Russell Shelley	Professor, Juniata College, Huntingdon
Mike Snavelly	Founder, Mission Imperative, Lebanon
Aimee Stiles	Administrative Assistant & Coach, Appalachian Bible College, Mount Hope, WV
Ian Thompson	Vice President, Standing Stone Consulting, Huntingdon
Tyler Trometer	Writer, BJU Press, Greenville, SC
Janet Tschida	Professor, Maranatha Baptist University, Watertown, WI

F.Y.I. / Reminders

Meal Tickets

Pre-ordered tickets were a part of the packet of materials picked up at KCEA's Registration Desk when your school arrived. Trade with each other or with other delegates. A limited number of tickets are available for exchange for the alternate meal time, if needed. Additional tickets are available for sale from KCEA's Registration Desk.

Remember.... The assigning of tickets to specific lunch periods:

- ◇ helps assure of less waiting in line
- ◇ assists DoubleTree's food service in their meal preparations.

Wear Your Name Badge

You know who you are, but others may not. Help others recognize you as being with the KCEA Conference. If you have no further need for your badge at the end of the Conference, return your holder to help save future Conference costs.

Offering

During the Conference we take two offerings as an opportunity for individual delegates to help with the cost of this professional in-service. Registration fees alone do not pay all of the cost.

Conference Recordings

Most workshops will be recorded. As in the past, a recording code has been assigned to each and noted in your Conference Guide. Look for the ☉ at the end of the workshop description.

All recordings will be made available to you **at no extra cost** following the Conference. As a delegate to this Conference, you will be able to access the complete list of successfully recorded sessions from the convenience of your personal computer. We will provide instructions.

Changes in Workshop Listings

If any changes need to be made after the Conference Guide "goes to press," changes will be announced, whether orally or visually via PowerPoint in the Assembly periods and on the two monitors located outside Statesmen Hall.

Feedback Sheets / Evaluation Forms

Fill in your sheet "as you go" or during a break in your schedule. Be honest but forthright and kind. We share all comments with each speaker and workshop leader for their personal professional growth.

Lost & Found / Message Center

Check with KCEA's Registration Desk.

Proverbs 2:1-9: Choose to Follow!

¹ My son, if thou wilt receive my words, and hide my commandments with thee;

² So that thou incline thine ear unto wisdom, and apply thine heart to understanding;

³ Yea, if thou criest after knowledge, and liftest up thy voice for understanding;

⁴ If thou seekest her as silver, and searchest for her as for hid treasures;

⁵ Then shalt thou understand the fear of the LORD, and find the knowledge of God.

⁶ For the LORD giveth wisdom: out of his mouth cometh knowledge and understanding.

⁷ He layeth up sound wisdom for the righteous: he is a buckler to them that walk uprightly.

⁸ He keepeth the paths of judgment, and preserveth the way of his saints.

⁹ Then shalt thou understand righteousness, and judgment, and equity; yea, every good path.



TRAINING
GOD'S
SERVANTS
— FOR —
GOD'S
SERVICE



A FOUR-YEAR BIBLE COLLEGE SPECIALIZING IN MINISTRY TRAINING



**AMBASSADOR
BAPTIST COLLEGE**

704.434.0303
Lattimore, NC

www.ambassadors.edu
info@ambassadors.edu



Key to Codes

Target Audience

EC	Early Childhood
EL	Elementary
LEL	Lower Elementary
UEL	Upper Elementary
MS	Middle School
JH	Junior High
HS	High School
SEC	Secondary
PAS	Pastor
ADM	Administrator
OFF	Office
GEN	General

Room Designations

Look for the **□** following each workshop description.

First Floor

BF	Ben Franklin
EH	Edward Hand
RF	Robert Fulton
SA	Statesmen A
SB	Statesmen B
SC	Statesmen C
SD	Statesmen D
WPL	William Penn (Left)
WPR	William Penn (Right)

Second Floor

COVE	Starfish Cove
------	---------------

Third Floor

TER	Terrace Room
-----	--------------

Wedding Chapel

CH	Chapel
----	--------

CEU Qualified

Look for the **◆** following each workshop description.

Recorded Sessions

Look for the **◎** following each workshop description.



86 EAST OAK HILL ROAD | CHESTERTON, IN 46304

219-926-6636

www.fairhavenbaptistcollege.org

AMERICAN LIBERTY TOURS

*Exploring Our Legacy of Liberty and Faith
in Philadelphia and Beyond...*



Philly I - Foundations of Faith
Philly II - Paths of Liberty
Valley Forge -
The Price of Liberty
William Penn -
A Vision of Liberty and Faith
in the New World
Daniel Boone & Conrad
Weiser - Westward Bound
Hagley Museum & Huguenots
Pottstown & Rebecca Grace -
Faith, Industry &
Independence
William Tennent & the
Log College (Princeton)
Annapolis and More!!

Tours, Field Trips, or Classroom Presentations

Carris Kocher, Certified Tour Guide

★★★★★★

610-476-3482

AMERICANLIBERTYTOURS@GMAIL.COM

Visit us on FB or at AmericanLibertyTours.com

★★★★★★

AMERICAN LIBERTY TOURS is affiliated with
BILL OF RIGHTS BICENTENNIAL COMMITTEE
Publisher of select works on our Legacy of Liberty
and sponsor since 1991 of annual

Bill of Rights Commemorative Banquet

P.O. Box 912, Glen Mills, PA 19342



"Endowed by the Creator with Certain Unalienable Rights"

Bill of Rights Bicentennial Committee

Offering a choice selection of prints & reprints including:

The Christian Philosophy of Patrick Henry 1960

The Americanism of Washington 1906

William Penn's Trial 1670

Divine & Moral Songs for Children by Isaac Watts 1715

Franklin Speaks, Select Quotes 2006

*Mark your
calendar for
Bill of Rights Day
December 15th
The first ten
amendments to the
US Constitution were
ratified Dec. 15, 1791*

Sponsoring annual Bill of Rights Commemorative Banquet on Dec. 15th

For more information or free listing contact:

BILL OF RIGHTS BICENTENNIAL COMMITTEE
P.O. Box 912, Concordville, PA 19331 * (610) 476-3482

Christian, Patriotic, & Historical

kohercj@verizon.net

Prints & Reprints

Your Assembly Speakers

Dr. Russell Shelley previously taught secondary music classes in New York and served as a church musician. He earned his Ed.D. from Penn State. He now serves as Director of Choral and Vocal Studies and as Chair of the Department of Music at Juniata College, as well as music director of the State College



Choral Society. Russ has lectured internationally and has appeared as a guest conductor more than forty times in seven states. In November he again will minister as clinician/conductor of KCEA's All-State Choir.

Missionary Donald Kilmer is a farm boy from Lancaster County, PA, who loves Jesus and the Bible. He and his wife Karen were sent to South Africa from Mountain View Bible Church (Hummelstown, PA) in 1993 to work among the Zulu with evangelism, discipleship, training, and church planting. Previous to his foreign missions work, Donald gained experience as a pastor and substitute teacher. In South Africa, he regularly preaches and substitute teaches in government schools, runs literacy classes, and teaches as an adjunct professor at Solid Rock Baptist Institute.



Dr. Roger Bradley is an alumnus of BJU, earning both a Bachelor of Science and a Master of Education degree. He subsequently earned a Ph.D. in Applied Economics from Clemson. Roger has taught a variety of history and economics courses, including American Economic History, European Economic History, Intermediate Macroeconomics, Money and Banking, and seminars on Marxism and the Industrial Revolution. Roger has actively served as a deacon and a teacher in his local church.



Dr. Alton Beal was born again at the age of 15 through the ministry of Neighborhood Bible Time. To further his preparation for the ministry, Alton enrolled at Ambassador Baptist College (then located in Shelby, NC) and graduated in 1996. Since graduation, he has traveled extensively as an evangelist serving in local churches and Christian camps all across America. Now president of ABC, he helps mentor the next generation of preachers and Christian workers. ABC specializes in preparing for Christian vocations.



Thursday Conference Schedule

Workshop 1

Thursday: 8:45—9:35 a.m. (Early Bird)

AN OUTWARD EXPRESSION OF AN INWARD CHANGE. (EL) *Brooke Greening*. Can you and your students say that Bible time is your favorite part of the day? Teach your students character qualities and spiritual applications through effective story-telling. □ RF ♦ CEU ☉ 19-01-01

CAN YOU USE TECHNOLOGY IN YOUR CLASSROOM? (SEC) *Pam Litzenberger*. Today's young people live with cell phones, tablets, and computers invading every part of their lives—except the classroom. We need to find ways to use this technology to inspire learning and enhance the classroom experience. In this workshop, we will discuss how to incorporate technology into our teaching, even on a budget. Several apps and programs will be discussed. □ TER ♦ CEU ☉ 19-01-02

COULD YOU BE SUBJECT TO MINISTRY-THREATENING ACCUSATIONS? CAN YOU REDUCE

THE PROSPECT OF AN ACCUSATION? (GEN) *Ian Thompson*. Accusations can come from a variety of individuals and be related to a wide range of alleged conduct. Even if totally unfounded, accusations bring damage, even crippling damage at times. In this session, we will offer practical but proven ways to reduce the prospect of facing an accusation in one's ministry as pastor, principal, teacher, or office staffer. (To be repeated in Workshop 12.) □ BF ♦ CEU ☉ 19-01-03

IMPROVING YOUR ADMINISTRATIVE COMMUNICATION SKILLS. (ADM) *Dr. Brian Carruthers*. The school administrator has a number of stakeholders (school board members, parents, faculty members, students) with which to continuously communicate. This workshop explores the importance of quality communication skills as well as how to utilize technology in making the process more efficient. □ WPR ♦ CEU ☉ 19-01-04

MUSIC TO ENHANCE LEARNING IN THE CONTENT AREAS. (EL, JH) *Dee Long*. One of God's gifts to us is music. It is a tool to enhance learning throughout the content areas and ages of our classrooms. Resources will be presented, and you will be encouraged to share thoughts and experiences. Musical ability is not needed to incorporate this gift from God! (To be repeated in Workshop 5.) □ EH ♦ CEU © 19-01-05

THE LIBERAL ARTS – WHY THEY ARE IMPORTANT AND HOW TO PREPARE STUDENTS TO EMBRACE

THEM. (GEN) *Dr. Roger Bradley*. Demonstrating the benefits of the liberal arts to high school and college students and why the STE(A)M push is not completely appropriate. □ COVE ♦ CEU © 19-01-06

WHEN BUTTERFLIES BECOME BABOONS – DEALING WITH PERFORMANCE ANXIETY. (GEN) *Janet Tschida*. In spite of careful preparation, do your nerves get the better of you time and again? If yes, this workshop is for you! Learn practical strategies for channeling your nervous energy so that it starts working for instead of against you! □ WPL ♦ CEU © 19-01-07



MORNING GENERAL ASSEMBLY

Thursday: 9:45 a.m.

□ Statesmen Hall
♦ CEU
© 19-A-01

Education Address

Dr. Russell Shelley

“ARE WE PENCILS OR PENS?”

Let's spend some time thinking about the attributes of both and see how our past practices inform whether or not we are what we think we are.

Main Address

Missionary Donald Kilmer

“LET YOUR LIFE BE YOUR BEST TEACHING TOOL”

Ministering to others, we lead them to truth; in leading them to truth, we are followers of Jesus. Your life is the best teaching tool you have.

Workshop 2

Thursday: 11:45 a.m.—12:35 p.m.

ART OF EXPLAINING. (GEN, ADM) *Eric Bryant*. Teaching is a skill that can be developed. Part of that skill of teaching is being able to explain concepts in a way that all students can understand. This workshop will provide practical methods for explaining. □ TER ♦ CEU © 19-02-01

BY THE WAY~ LET'S TALK! (GEN) *Joy Budensiek*. Research by Dr. Jeff Myers of Summit Ministries found that 19 out of 20 Christian parents do not talk to their children about God and spiritual truth as they go about their daily living. That horrible statistic can change one family at a time! Let's take advantage of every opportunity to share our faith with those who are coming behind us. This interactive session will provide ideas, material, and methods to encourage both classroom and “around the supper table” discussions. (To be repeated in Workshop 12.) □ WPL ♦ CEU © 19-02-02

DIAGNOSING AND TREATING READING DIFFICULTIES. (EL) *Dana Davis*. Reading can be hard for some children for many reasons. Learn research-proven strategies that can be used to help your students overcome specific reading difficulties in the five essential areas of reading: phonemic awareness, phonics, fluency, vocabulary, and comprehension. □ SB ♦ CEU © 19-02-03

HELPING YOUR STUDENTS DEVELOP CRITICAL THINKING SKILLS. (EL, MS) *Ann Carruthers*. An interactive workshop exploring ways to integrate critical thinking skills in everyday teaching. □ CH ♦ CEU © 19-02-04

KCEA BOARD MEETING. (PAS, ADM) A time-

abbreviated meeting of the KCEA Board to conduct the business of the Association. The other five meetings are typically longer and undertake more in-depth discussions and decisions. (The first of a two-hour session. No CEU credit.) □ EH

LEADING A CHILD TO CHRIST. (EC, EL) *Dr. Jeff Davis*. God's plan of salvation is simple enough for a child to understand. This workshop will provide you with an organized way to explain salvation to children and help them put their faith in Christ. □ SA ♦ CEU © 19-02-05

MATH CLASS FUNDAMENTALS. (SEC) *Cindy Quinlan*. Designed for newer teachers, those that fall into the “Surprise, you're teaching math this year!” category, or veteran teachers seeking to review and strengthen their core practices, this session highlights the essential pattern for each math class that leads to smooth lessons, crisp explanations, and solid learning. □ COVE ♦ CEU © 19-02-06

MENACE OR MOTIVATOR (MUSIC). (EL, SEC) *Janet Tschida*. “My students just aren't talented.” “Of course the lesson was bad...he hasn't practiced for weeks!!” Sound familiar? Be inspired with pedagogical principles that transform every lesson into a motivating experience – successful students are motivated students. □ BF ♦ CEU © 19-02-07

OFFICE EFFICIENCY. (OFF) *Aimee Stiles*. You are the point or support person for the center of operations for your ministry. How do you juggle so many responsibilities? By learning how to effectively manage your office environment, schedule, people, and tasks. □ RF ♦ CEU © 19-02-08

EARN YOUR MASTER'S DEGREE ONLINE!

50% OFF THESE THREE PROGRAMS

- Teaching & Learning, MEd
- Educational Leadership, MS
- Master of Music Education

Learn more at scope.bju.edu/programs



BOB JONES UNIVERSITY
L E A R N . L O V E . L E A D .

Workshop 3

Thursday: 12:50—1:40 p.m.

BOOKS AND BEYOND: LIBRARY COLLECTION DEVELOPMENT. (GEN) *Michael Clater*. The importance of having a balanced perspective of your library collection relating to your purpose and mission. We will discuss practical methods, policies, and procedures to help you enhance your library's impact. □ SD ♦ CEU ☉ 19-03-01

COMMON ISSUES IN TEACHING MATH. (SEC) *Pam Litzenberger*. We face challenges every day when we teach math: late work, cheating, integrating technology, word problems.... The list goes on. How can we recognize the issues and then find a solution to meet each one? What are the most common issues in your classroom, and can you find a creative way to address them? □ RF ♦ CEU ☉ 19-03-02

INTRODUCTION TO IOWA AND CogAT ASSESSMENTS FOR GRADES K-12. (GEN) *Phillip Contompasis*. This session is ideal for (a) those schools that are considering assessing with Iowa (Achievement Test) and/or CogAT (Abilities Test) and (b) those school leaders who are new to a school's leadership but whose school uses these assessments. I will provide you with an overview of the Iowa and CogAT Assessments. I will explore the benefits and features of both assessments. Also, I will introduce you to the many different reports that you will receive through Data Manager, our online reporting system. (To be repeated in Workshop 7.) □ WPL ♦ CEU ☉ 19-03-03

KCEA BOARD MEETING. (PAS, ADM) (The second of a two-hour session. No CEU credit.) □ EH

THE PILLARS OF EVOLUTION. (GEN) *Mike Snavelly*. This session defines "science" and illustrates the scientific method of problem solving. In the light of true science, the three main concepts that the theory of evolution is based upon are examined and shown to be faith-based rather than science-based. This session will also give people some "tools" with which to combat the theory. □ SB ♦ CEU ☉ 19-03-04

THE ROBBER BARONS – NEITHER ROBBERS NOR BARONS. (SEC) *Dr. Roger Bradley*. A survey of the positive contributions of some of the early American industrial capitalists and how to discuss them positively without deifying them. □ TER ♦ CEU ☉ 19-03-05

UNDERSTANDING THE TEMPERAMENTS. (EC, EL) *Dr. Jeff Davis*. Do you understand what makes your students tick? Recognizing the temperaments of your students can help you understand how they best learn. □ SA ♦ CEU ☉ 19-03-06

WHAT IS A BIBLICAL WORLDVIEW? (GEN) *Tyler Trometer*. Our worldview influences every part of our life. As Christian educators we want to teach a biblical worldview to our students. This session will help you better articulate and apply a biblical worldview in the classroom. □ SC ♦ CEU ☉ 19-03-07

WINNING YOUR STUDENTS IN ARITHMETIC. (EL) *Brooke Greening*. Gain your students' attention from the start of arithmetic class with an effective review time. Learn how to visualize concepts for your students and engage reluctant learners. □ CH ♦ CEU ☉ 19-03-08

Workshop 4

Thursday: 2:00—2:50 p.m.

21ST-CENTURY SKILLS MOVEMENT. (GEN, ADM) *Eric Bryant*. There is a push in our nation for our children to possess 21st-century skills. What are those skills? How does this movement align itself for or against traditional teaching methods? □ COVE ♦ CEU ☉ 19-04-01

ARE YOU AN INSTRUCTIONAL LEADER? (ADM) *Dr. Brian Carruthers*. If one of the goals of your Christian school is to enhance student achievement, then what are you doing as its leader to promote its success? This workshop explores the job description of the "Chief Learning Officer" of the Christian school. □ WPR ♦ CEU ☉ 19-04-02

EFFECTIVE READING COMPREHENSION INSTRUCTION. (MS, HS) *Shawntel Chisholm*. What makes successful teachers of reading comprehension successful? How can you better help your students learn to read effectively? This workshop will take you through the reading process – before reading, during reading, and after reading – and essential elements of effective reading comprehension instruction. Don't worry – many practical strategies and tips are included! □ TER ♦ CEU ☉ 19-04-03

HELP FOR THE DYSLEXIC AND SEVERELY DELAYED READERS IN YOUR CLASSROOM. (GEN) *Dana Davis*. Learn research-proven strategies to help the dyslexic and severely delayed reader in your classroom. □ SB ♦ CEU ☉ 19-04-04

INDIVIDUALIZING INSTRUCTION IN THE ELEMENTARY GRADES. (EL) *Ann Carruthers*. Each year your classroom includes students who come from a variety of backgrounds, each with unique learning styles and different levels of reading. Your challenge in this environment will be to identify ways to individualize your instruction in order to best meet the academic needs of each of these students. This workshop explores a variety of student characteristics usually found in today's classroom as well as instructional strategies to help them meet your academic goals for the year. □ CH ♦ CEU ☉ 19-04-05

LEARNING IMPORTANT TRUTHS FROM "THE OTHER SIDE OF THE FENCE" ABOUT STUDENT EDUCATIONAL TIME-ON-TASK. (PAS, ADM, GEN) *Ian Thompson*. While the presenter is deeply committed to the Scriptures, his church, and Christian education, he also serves on two public school boards and is an active leader within the PA School Boards Association. He has worked with hundreds of K-12 schools as well as colleges and universities. With this background, and with his use of the Scriptures, in this session he shares important material that can aid Christian educators. This session addresses practical issues relating to school policies and practices such as subjects like: (a) length of school day and school year, (b) effectively using available time for education, (c) skipping a grade, (d) early graduation, (e) dual enrollment, (f) enforcing attendance/truancy, and (g) "educational trips"/vacations. (Hint: there is also much one should not

VERITAS

AN ONLINE BAPTIST COLLEGE

Affordable.

Flexible.

Accredited.

Christian school educators
receive a 30% discount in
tuition for our MCEd program.

TRUTH MATTERS



vbc.edu

emulate from “the other side.”) (*To be continued in Workshop 5. A 100-minute session. Must attend entire session for a total of 2/10 CEU credit.*) □ WPL ♦ CEU ☉ 19-04-06

OVERCOMING MATH ANXIETY. (SEC) Pam Litzenberger. A quarter to half of pre-college students have math anxiety. In this workshop, we will discuss this fear, where it may have originated, and more importantly how we, as their math teachers, can help our students overcome their anxiety. Also discussed will be math myths and how these affect our students. □ RF ♦ CEU ☉ 19-04-07

PREPARE – PRESENT – PRACTICE (MUSIC). (EL) Janet Tschida. Set your students up for success by aurally and physically preparing new concepts before visually presenting and reinforcing with practice assignments. A variety of “prepare – present – practice” examples will be demonstrated using concepts commonly introduced in beginning levels of piano methods or in general music classes. □ BF ♦ CEU ☉ 19-04-08

TEACHING ELEMENTARY SCHOOL BIBLE. (EL) Dr. Hubert Hartzler. This workshop defines and describes creative Bible teaching in the elementary classroom. A “pattern” of teaching the Bible is presented which is designed to lead students from knowing about God to knowing Him. □ SA ♦ CEU ☉ 19-04-09

THAT’S NOT TRUE! DEVELOPING CRITICAL THINKING THROUGH THE SCHOOL LIBRARY IN THE AGE OF FAKE NEWS. (GEN) Michael Clater. Your library is a key tool in teaching your students critical thinking. Regardless of what book is being read, critical thinking can be applied. Join this interactive session as we present and discuss practical ways you can work with your students through their library assignments – whether in print or online. □ SD ♦ CEU ☉ 19-04-10

THE STATE OF CHRISTIAN SCHOOL ATHLETICS. (GEN) Bob Eble. A brief look at current rule changes and interpretations in the sports of volleyball, soccer, and basketball with an emphasis on their application to the Christian school. Content will be from the National Federation rulebooks and not exclusive to Pennsylvania (PIAA) or KCEA tournaments. □ SC ♦ CEU ☉ 19-04-11

WILLIAM PENN—RELEVANT IN THE 21ST CENTURY? (GEN) Carris Kocher. Born in the midst of massive upheavals in government and society, William Penn came of age during a seismic crossroads in human history. At this crucial intersection would he choose comfort, ease, and accommodation? Or would he pursue God and a clear conscience? Learn more about who he was, what he suffered, and what he put in motion that still resonates today. □ EH ♦ CEU ☉ 19-04-12

Workshop 5

Thursday: 3:15—4:05 p.m.

CONNECTING THE DOTS: INTEGRATING OTHER SUBJECTS INTO THE HISTORY CLASSROOM. (EL, SEC) Dr. Mary Barclay. If history is the study of life in the past, why do we try to teach it in a vacuum? Learn how to integrate other subjects (English, math, science, music, etc.) into your classroom without having to go back to college to add another three bachelors’ degrees to your resume. □ RF ♦ CEU ☉ 19-05-01

DIRECTION AND CHORAL TECHNIQUES, PART I. (SEC, GEN) Dr. Russell Shelley. This is a choral reading clinic encompassing the choral numbers that have been selected for KCEA’s All-State Choir event in November. The content will be helpful for any choral leader but will be extremely important for any choral leader/tutor assigned to help prepare the high school students for the auditions and then participation. (*To be continued in Workshop 6. A 100-minute session. Must attend entire session for a total of 2/10 CEU credit.*) □ BF ♦ CEU

GO BEYOND HEAD KNOWLEDGE TO REACH THEIR HEART. (EL) Brooke Greening. Do you need some help with “that” student? Do you wish it were already the end of the year? Incorporate biblical principles for effective classroom management so you reach the heart of each student, not just their head. □ SB ♦ CEU ☉ 19-05-02

HOW ECONOMICS CAN HELP YOU UNDERSTAND YOUR STUDENTS. (HS, ADM) Dr. Roger Bradley. Basic principles of economics illustrated by students and their families. □ EH ♦ CEU ☉ 19-05-03

LEARNING IMPORTANT TRUTHS FROM “THE OTHER SIDE OF THE FENCE” ABOUT STUDENT EDUCATIONAL TIME-ON-TASK. (PAS, ADM, GEN) Ian Thompson. (*Continued from Workshop 4. A 100-minute ses-*

sion. Must attend entire session for a total of 2/10 CEU credit.) □ WPL ♦ CEU ☉ 19-05-04

MUSIC TO ENHANCE LEARNING IN THE CONTENT AREAS. (EL, JH) Dee Long. One of God’s gifts to us is music. It is a tool to enhance learning throughout the content areas and ages of our classrooms. Resources will be presented, and you will be encouraged to share thoughts and experiences. Musical ability is not needed to incorporate this gift from God! (*A repeat of Workshop 1.*) □ WPR ♦ CEU ☉ 19-05-05

SMOOTHING THE RESEARCH-PAPER ROAD. (SEC) Cindy Quinlan. The research paper is just one of many opportunities students have to develop their communication and writing skills. As we go through the steps of the research paper, we’ll look at a number of ideas that can lead to a smoother and more effective research paper process for all involved. □ TER ♦ CEU ☉ 19-05-06

SUPPORTING YOUR STAFF. (ADM) Aimee Stiles. We are called to Christian education, but that does not eliminate difficult times. Help your staff thrive as they experience your understanding, guidance, and encouragement. □ COVE ♦ CEU ☉ 19-05-07

THE FUN STUFF OF PRESCHOOL. (EC) Susan Crago. In this session you should be prepared to (1) share apps you love, (2) share at least one fun fingerplay, (3) bring and share a list of theme weeks for your classroom, and (4) be prepared to discuss/share science experiments. Come join the fun of preschool! □ SD ♦ CEU ☉ 19-05-08

THE UNSEEN MINISTRY OF THE TEACHER. (GEN) Dr. Alton Beal. Teachers spend years of preparation to learn to teach. However, teaching is not enough. The Christian school teacher must also be faithful to pray for the students. See the tenderness and the prayers of Paul and have that same heart for your students. □ CH ♦ CEU ☉ 19-05-09

WHAT IS A GOOD CHRISTIAN TEACHER? (PAS, ADM, GEN) *Eric Bryant*. This workshop will focus on ten characteristics of good Christian teachers. □ SA ♦ CEU © 19-05-10

WHAT MAKES EDUCATION CHRISTIAN? (GEN) *Tyler Trometer*. Our students may understand how the Bible relates to life at church or at home. But do our students know how the Bible influences how they study history, science, or even math? This session demonstrates how you can teach your discipline from a biblical worldview. □ SC ♦ CEU © 19-05-11

Workshop 6

Thursday: 4:30—5:20 p.m.

A HANDS-ON TRAINING SESSION ON DATA MANAGER AND OUR NEW ONLINE INTERFACE. (ADM, GEN) *Phillip Contompasis*. You will be greatly advantaged if you come to this session **with a laptop computer and your school's login information** for Data Manager. When a school administers the Iowa and/or CogAT assessment, the school receives a computer full of practical helps, not just a simple written report of basic results. We will: (a) Examine Reading Domains and Standards as they appear in the reports, (b) Examine Math Domains and Standards as they appear in the reports, (c) Look at Web Keys (will allow teachers to access their students' results online), and (d) Look at Data Manager digital resources and reporting activities for both Iowa and CogAT. These reports will help your school understand your students and curriculum strengths and weaknesses. (A 75-90-minute session, depending on questions. To be repeated in Workshop 8.) □ WPR ♦ CEU © 19-06-01

A UNIQUE WAY OF INCORPORATING ENVIRONMENTAL SCIENCE AND THE PA ENVIROTHON INTO YOUR HIGH SCHOOL. (SEC) *Christal Edwards*. In this session we will briefly consider five important points for offering an environmental science class as part of a high school student's education. We will go over what the PA Envirothon is and how to incorporate it into your classroom. Helpful internet resources will be available. Ideas for inexpensive specimen collections will be offered. Books and other items will be available for you to look at. □ RF ♦ CEU © 19-06-02

CULTURES, CHRISTIANITY, AND CONFLICTS. (GEN) *Donald Kilmer*. As a missionary to South Africa, I faced, and continue to face, differences in cultures. But this is not new as I grew up in rural Lancaster County, PA, and went to college in a metropolitan city. In this session I will highlight cultural differences I have experienced and how I continue to endeavor to improve my effectiveness as I encounter them. (To be repeated in Workshop 12.) □ SC ♦ CEU © 19-06-03

DIRECTION AND CHORAL TECHNIQUES, PART II. (SEC, GEN) *Dr. Russell Shelley*. (Continued from Workshop 5. A 100-minute session. Must attend entire session for a total of 2/10 CEU credit.) □ BF ♦ CEU

FOUR THINGS EVERY YOUNG ADMINISTRATOR SHOULD REMEMBER. (PAS, ADM) *Dr. Alton Beal*. Being the administrator of a Christian school is an incredible responsibility. Your decisions impact the church, the school staff, and the students. If you are a younger school administrator and feel overwhelmed, pause to remember some key considerations that will help you in your decision-making. □ CH ♦ CEU © 19-06-04

HOW TO TEACH BOYS DIFFERENTLY THAN GIRLS. (GEN) *Tim Anger*. Boys are different than girls. Are there techniques for effectively *teaching* boys differently than girls?

Learn five strategies that will help you engage the male half of your class. □ TER ♦ CEU © 19-06-05

I HAVE NO IDEA WHAT THIS MEANS!: MAKING SENSE OF YOUR FINANCIAL REPORTS. (PAS, ADM, OFF) *J. Andrew Barclay*. Have you ever read a financial report and felt like you were reading a foreign language? Have you ever been unsure what to include in a financial report? This workshop is designed to help both the creators of and interpreters/readers of financial reports. Regardless of which computer program you use, this workshop will aid you in your processing, reporting, and interpreting of financial information so that your ministry can follow best business practices. □ COVE ♦ CEU © 19-06-06

IMPLEMENTING SURVIVAL TECHNIQUES FOR THE FIRST-YEAR TEACHER. (ADM) *Dr. Brian Carruthers*. All of us have memories of our first year of teaching...some positive...and some not so positive! Research shows that many "rookie" teachers give up after one or two years of teaching. This workshop will look at what administrators should be doing to help the first-year teacher attain a sense of success in an otherwise overwhelming experience. □ EH ♦ CEU © 19-06-07

INTEGRATING A FOREIGN LANGUAGE IN CLASSROOM INSTRUCTION. (EL) *Ann Carruthers*. This workshop will provide the classroom teacher with a variety of ways to integrate a foreign language in everyday teaching and activities. □ WPL ♦ CEU © 19-06-08

PRESCHOOL. LET'S BEGIN.... BUT HOW DO WE START??? (EC) *Susan Crago*. In this session we will focus on three aspects of preschool. (1) Programs: Bring your handbooks and your schedules of the day and let's put our heads together to improve our programs. (2) Communication: Do you do a weekly email, a monthly calendar to communicate with parents? (3) Resolution: We will share our biggest tips for dealing with parents. □ SD ♦ CEU © 19-06-09

TRANSFORM YOUR TEACHING: INSTRUCTIONAL STRATEGIES THAT WORK AND THE TECH TOOLS THAT CAN HELP. (GEN) *Dana Davis*. Use proven instructional strategies and engaging technology tools to transform your teaching. □ SA ♦ CEU © 19-06-10

USING STORYTELLING, QUESTION AND ANSWER, AND DRAMATICS AS TEACHING METHODS IN ELEMENTARY BIBLE AND HISTORY. (EL) *Dr. Hubert Hartzler*. Are your students actively involved in the learning process in your Bible and history classes? This workshop will help you use three methods to create interest in the lesson and to relate truths from God's Word and from "His story" to their own lives. □ SB ♦ CEU © 19-06-11

"A good example is far better than a good precept." - Dwight L. Moody

Be one of the first
to see our
newest products,
including these...

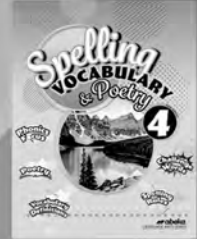

4th Grade
Spelling, Voc., Poetry



4th Grade
Song of the Brook

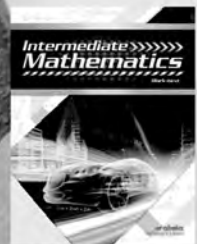

7th Grade
Intermediate Math

Free Samples Waiting for You!
Visit Abeka's booth to find out more.



Biblical Worldview ■ Research & Development ■ Proven Philosophy ■ Critical Thinking



MAR COR MINISTRIES



Have Gunny and Bob join you for your next event. We travel from Maine to South Carolina sharing our presentation. Let us share our simple yet profound message called *Trust and Obey* with your church, school, or group.

Visit our website to see Gunny in action!

MARCORMINISTRIES.ORG

Friday Conference Schedule

MORNING PRAYER

(7:30 – 7:55)

Men: Ben Franklin / Ladies: Robert Fulton

Workshop 7

Friday: 8:00—8:50 a.m.

ARE YOU PREPARING YOUR STUDENTS FOR LIFE OR JUST GETTING THEM THROUGH SCHOOL?

(PAS, ADM, GEN) *Ian Thompson*. In this session we will provoke to thought and maybe even inspire some changes. Is your definition of curriculum too narrow? What are you doing about life readiness? How are you addressing spiritual, emotional, self-discipline, and decision-making maturity? Upon graduation, are your students ready for life at college, in the military, or in the workplace? RF CEU 19-07-01

ATHLETIC COACHING. (GEN) *Aimee Stiles*. Perhaps you have played a sport at some time in your life or maybe you received a college sports scholarship. Whatever your background, whether willingly or out of necessity, you are now coaching! Addressing the opportunity, objectives, and obstacles of coaching, this session is applicable to any level or sport. SC CEU 19-07-02

CHANGING OUR MINDSET IN ORDER TO MOVE FORWARD. (EL, JH) *Dee Long*. Students say, "I can't!" "I don't know how!" "It's too hard!" Let's help each student have strategies to change a negative mindset and move forward! SD CEU 19-07-03

CRITICAL THINKING AND PEDAGOGY. (GEN, ADM) *Eric Bryant*. This workshop will explore the idea of getting students to think in the classroom. Attention will be given to the background and current trend of critical thinking. WPL CEU 19-07-04

ELEMENTARY LEVEL CHORDING FOR SING-ALONGS AND ACCOMPANYING. (EL, MS) *Janet Tschida*. Learn how to quickly structure easy, impressive-sounding chording arrangements for your elementary level students (equivalent to Faber Level 1 and up) so that they can experience the thrill of accompanying instrumentalists and playing for sing-alongs early in their music study. Additional benefits include developing aural skills, understanding chordal harmonization, thinking form, and weaving melodic motifs during the elementary level of piano instruction (repertoire will primarily be traditional and sacred tunes). BF CEU 19-07-05

ESSENTIALS OF THE HIGH SCHOOL ECONOMICS COURSE. (HS, ADM) *Dr. Roger Bradley*. Suggestions for those who are asked to teach economics, with particular attention to those who have little background in economics. EH CEU 19-07-06

INTRODUCTION TO IOWA AND CogAT ASSESSMENTS FOR GRADES K-12. (GEN) *Phillip Contompasis*. This session is ideal for (a) those schools that are considering assessing with Iowa (Achievement Test) and/or CogAT (Abilities Test) and (b) those school leaders who are new to a school's leadership but whose school uses these assessments. I will provide you with an overview of the Iowa and

CogAT Assessments. I will explore the benefits and features of both assessments. Also, I will introduce you to the many different reports that you will receive through Data Manager, our online reporting system. (A repeat of Workshop 3.) WPR CEU 19-07-07

LEVELING, NOT LABELING. (EL) *Dana Davis*. Knowing the reading levels of books can help teachers make better decisions about the texts included in their classroom. Understand the differences between leveled reading systems and choose a system that works best for your classroom. Plus – tips for quickly determining the level of a book and strategies for organizing your classroom library. CH CEU 19-07-08

QUICKBOOKS: THE ESSENTIALS FOR BEGINNER TO INTERMEDIATE USERS, PART I. (ADM, OFF, GEN) *J. Andrew Barclay*. QuickBooks is quickly becoming one of the most popular financial computer programs available on the market and comes with an affordable price tag for non-profits. Whether you are considering purchasing QuickBooks, have recently switched from other software to QuickBooks, or are a relatively new user to QuickBooks, this workshop will have something for you! Please note: This workshop is not designed for advanced QuickBooks users. (To be continued in Workshop 8. A two-hour session. Must attend entire session for a total of 2/10 CEU credit.) COVE CEU 19-07-09

TEACHING AND LEARNING IN THE 21ST CENTURY. (GEN) *Dr. Brian Carruthers*. Students leaving our schools will be expected to successfully manage the complexity and diversity of the world in which they will live. These students come to our classrooms with new skills and expectations, and it is the responsibility of the teacher to help them navigate the road map to future success. This workshop will explore this new paradigm and will challenge teachers to be ready to accept the challenge of helping students be ready to face their future. TER CEU 19-07-10

THE POWER OF LITERATURE: DEVELOPING ARTICULATE THINKERS. (SEC) *Cindy Quinlan*. The study of literature is more than merely acquainting our students with great works and authors. Rather, literary study should challenge students not only to think but to articulate and defend those thoughts. Understanding the power and promise to be found in literature can help the teacher prepare and present the material as he skillfully leads his students in reading, analyzing, and discussing literature. SA CEU 19-07-11

WHY IS CHRISTIAN EDUCATION FADING IN THE CHURCH? (PAS) *Dr. Alton Beal*. Why is Christian school attendance in some areas decreasing? How can pastors better educate their congregations about the need for Christian education? Since Christian education is more important now than ever, these questions and more need to be answered and addressed. SB CEU 19-07-12

Workshop 8

Friday: 9:15—10:05 a.m.

A HANDS-ON TRAINING SESSION ON DATA MANAGER AND OUR NEW ONLINE INTERFACE. (ADM, GEN) *Phillip Contompasis.* You will be greatly advantaged if you come to this session **with a laptop computer and your school's login information** for Data Manager. When a school administers the Iowa and/or CogAT assessment, the school receives a computer full of practical helps, not just a simple written report of basic results. We will: (a) Examine Reading Domains and Standards as they appear in the reports, (b) Examine Math Domains and Standards as they appear in the reports, (c) Look at Web Keys (will allow teachers to access their students' results online), and (d) Look at Data Manager digital resources and reporting activities for both Iowa and CogAT. These reports will help your school understand your students and curriculum strengths and weaknesses. (A 75-90-minute session, depending on questions. A repeat of Workshop 6.)
 WPR CEU 19-08-01

CONSIDER SOME COMMON SENSE HELPS FOR TEACHING "SLOW" STUDENTS. (EL, SEC) *Donald Kilmer.* In this session it is not my purpose to address pedagogy with those diagnosed with special needs, but those who are "late bloomers" or have a modest aptitude level. CH CEU 19-08-02

CURRENT AND TRADITIONAL PARADIGMS OF EDUCATION. (GEN, ADM, PAS) *Eric Bryant.* In this workshop, we will discuss the teacher-centered and the student-centered classroom. WPL CEU 19-08-03

HONORING GOD IN MATHEMATICS. (EL, JH) *Dee Long.* Where did mathematics come from? Why does it consistently work across time and culture? Let's discuss thoughts to naturally and genuinely honor God in any age math class. (To be repeated in Workshop 12.) SD CEU 19-08-04

IDEAS FOR TEACHING SPANISH IN THE ELEMENTARY CLASSROOM. (EC, EL) *Ann Carruthers.* This workshop will provide pre-school and elementary teachers a variety of ideas on how to make the study of the Spanish language an exciting adventure for their students. SC CEU 19-08-05

IMPROVISATION (MUSIC) FOR THOSE WHO "THINK THEY CAN'T." (EL, GEN) *Janet Tschida.* If improvisation intimidates you or your students, this is your time! Learn a fool-proof approach for beginning a "free improvisation journey." This session also includes how to successfully incorporate basic composition and chording into elementary piano lessons. BF CEU 19-08-06

LOST SECRETS OF THE ANCIENT CIVILIZATIONS. (GEN) *Mike Snavely.* With fascinating illustrations, this session contrasts the evolution model with the creation model from a historic standpoint through a look at what many ancient cultures were able to accomplish. It contrasts some of these civilizations to our own. SB CEU 19-08-07

MANAGING THE PROCESS OF EXCLUDING, DISENROLLING, OR EXPELLING A STUDENT FROM YOUR SCHOOL. (PAS, ADM) *Ian Thompson.* In this session we will cut through all of the somewhat normal clichés and get to real issues. The three words that modify the word "process" are not accidental. There is a time for each, but we seek to improve the "process" by which you go about to exclude a student from attending your Christian school. The "process" is important. If you employ a "bad process," you increase the likelihood of compounding your workload in diverse ways. RF CEU 19-08-08

NOT YOUR PARENTS' COPY MACHINE. AN INTRODUCTION TO EDUCATION APPS ON A COPY MACHINE. (GEN) *Kyocera.* Hundreds of apps available for our modern cell phones and devices assist many of us with our tasks. Although this session is presented by a representative from one copier company, apps on available copy machines can aid classroom teachers. EH

QUICKBOOKS: THE ESSENTIALS FOR BEGINNER TO INTERMEDIATE USERS, PART II. (ADM, OFF, GEN) *J. Andrew Barclay.* (Continued from Workshop 7. A two-hour session. Must attend entire session for a total of 2/10 CEU credit.) COVE CEU 19-08-09

RAISING RIGOR WITH THE 2 Rs. (SEC) *Cindy Quinlan.* Technically, every secondary student can read and write, but does he read and write well? No matter the subject you teach, you can help your students in improving these essential skills. This session – which particularly benefits English, science, history, and Bible teachers – presents simple strategies to incorporate into your reading assignments and class discussions that will help students read with greater comprehension and express themselves with greater clarity. SA CEU 19-08-10

STRATEGIES FOR TEACHING FROM A BIBLICAL WORLDVIEW. (GEN) *Tyler Trometer.* Do your attempts to shape a biblical worldview in your students feel redundant or unconvincing? Teaching from a biblical worldview in every discipline, whether literature or math, is challenging but essential to Christian education. Come learn several strategies for teaching from a biblical worldview. TER CEU 19-08-11

John 10:27-28

My sheep hear my voice, and I know them, and they follow me: And I give unto them eternal life; and they shall never perish, neither shall any man pluck them out of my hand.



I Corinthians 11:1-2

Be ye followers of me, even as I also am of Christ. Now I praise you, brethren, that ye remember me in all things, and keep the ordinances, as I delivered them to you.

William Penn 375

1644 – 2019

and his

“Holy Experiment”

A Worthy Example in Christian Character, Citizenship, & Government

An Honorary Citizen of the United States



- * He forsook the greatest of worldly advantages that he might follow Christ.
- * He suffered imprisonment for conscience sake.
- * He founded Philadelphia and Pennsylvania as a haven of freedom for the conscience of his fellow man – not just Quakers and Englishmen, but souls from all over the world.

- * He established the freest government in the world in the 1600s, securing freedom of conscience, representative government, and the right to trial by jury.
- * He dealt honestly and fairly with Native Americans.



Gentleman, Courtier, Quaker, Preacher,
Man of Letters, Visionary, Statesman,
Lawgiver, Diplomat, Founder and
Proprietor of Pennsylvania,
Author of the Great
Charter of Privileges of 1701,
Commemorated with the Liberty Bell, 1752

Educational Resources Online...

“The Life and Legacy of William Penn,” Providence Forum

<https://providenceforum.org/story/life-legacy-william-penn/>

“A Vision of Love,” American Bible Society – Faith and Liberty Discovery Center

<https://faithandliberty.org/visions/william-penn#>

“In Penn’s Shadow (1680-1720) – Philadelphia: The Great Experiment”

29 minute video, 2nd in a series produced by History Making Productions, 2014

<https://www.historymakingproductions.com/philadelphia-the-great-experiment-2>

Ed. Materials for “In Penn’s Shadow” targeting 4th, 5th, & 8th grade Social Studies

<https://www.historymakingproductions.com/philadelphia-the-great-experiment>

Unit Plans for “William Penn & the Founding of PA,” Historical Society of Pennsylvania

<https://hsp.org/education/unit-plans/william-penn-and-the-founding-of-pennsylvania>



KCEA
Conference
2019

Workshop 9

Friday: 10:30—11:20 a.m.

**“I AM AN INDIVIDUAL WITH A DIFFERENCE FROM THE MAJORITY OF YOUR STUDENTS.
DO YOU CARE ENOUGH SO THAT I WILL BE ENROLLED IN YOUR SCHOOL
AND BE SUCCESSFUL IN MY LIFE?”**

“I AM AN **ADOPTEE** (OR FROM A BLENDED HOME). WILL YOU HELP ME?” (GEN) *Joy Budensiek*. “A” STANDS FOR ADOPTEE IN YOUR CLASSROOM. There’s a big chance (and growing) you will have an adoptee (or student from a blended family) in your classroom. They bring a unique mix of nature and nurture. Get a “jump start” by understanding adoption language and awareness, possible developmental and sense of loss/bonding issues and understanding some of those scary “unknowns.” Discussion welcome. □ BF ♦ CEU
Ⓞ 19-09-01

“I AM A **RACIAL MINORITY**. WILL YOU HELP ME?” (GEN) *Aimee Stiles*. RACIAL ISSUES. In a society that screams diversity, how can our minority students understand their unique identity yet feel included in our Christian schools and churches? □ RF ♦ CEU Ⓞ 19-09-02

“I AM SUFFERING FROM **ELECTRONIC SCREEN SYNDROME**. WILL YOU HELP ME?” (GEN) *Dr. Hubert Hartzler*. THE INCONVENIENT TRUTH ABOUT ELECTRONIC SCREEN MEDIA: HOW IT AFFECTS A CHILD’S BRAIN AND BODY AND WHAT TO DO ABOUT IT. There is a solid consensus in the medical community that electronic screen-time is associated with multiple adverse outcomes. This workshop will identify important findings from the research of *Reset Your Child’s Brain: A Four-Week Plan to End Meltdowns, Raise Grades, and Boost Social Skills by Reversing the Effects of Electronic Screen-Time*. □ SB ♦ CEU Ⓞ 19-09-03

“I HAVE A **SERIOUS FOOD ALLERGY**. WILL YOU HELP ME?” (OFF, GEN) *Karen Harris*. MEDIC ALERT! Allergies are on the rise, and the health and welfare of our stu-

dents are our responsibility while in our classrooms. What policies and practices are in place in your classroom and school to address this rising concern? Come learn what we can do to help ensure the safety of our students. □ TER ♦ CEU
Ⓞ 19-09-04

“I HAVE **ADHD**. WILL YOU HELP ME?” (GEN) *Sara Atwood*. TEACHING THE CHILD WITH ADHD. Students with ADHD really do want to learn. Understanding how to bring out the best in them will help alleviate frustrations for you and them. □ CH ♦ CEU Ⓞ 19-09-05

“I HAVE BEEN CONFIRMED TO BE A **GIFTED STUDENT**. WILL YOU HELP ME?” (GEN) *Dr. Mary Barclay*. THE NATURE AND NEEDS OF GIFTED STUDENTS. Much emphasis is placed upon students who face learning challenges and those who struggle in the classroom, and rightfully so! Yet, what about those at the opposite end of the spectrum – the gifted? The gifted face many educational and emotional challenges, and their needs are frequently unmet or not understood. This workshop will focus on correcting myths related to gifted learners, explain the wide-ranging characteristics of the gifted, and provide some practical ideas of how to better meet the needs of gifted learners in the classroom, regardless of what subject you teach. □ SC/D ♦ CEU Ⓞ 19-09-06

“I HAVE SUFFERED A **SIGNIFICANT TRAUMA**. WILL YOU HELP ME?” (GEN) *Dana Davis*. TRAUMA INFORMED TEACHING. Scientific research has found that the link between childhood trauma and trouble at school is strong. Learn skills to better manage traumatized students in your classroom in school. □ SA ♦ CEU Ⓞ 19-09-07

Workshop 10

Friday: 11:45 a.m.—12:35 p.m.

BUILDING SKILLS FOR READING COMPREHENSION. (EL) *Brooke Greening*. Receive concrete tools for an effective elementary reading class that will build reading comprehension and help students improve their reading skills. □ CH ♦ CEU Ⓞ 19-10-01

BUT I KNOW THIS ALREADY! HELPING YOUR STUDENTS UTILIZE CLEP EXAMS TO EARN COLLEGE CREDIT. (HS, ADM) *Dr. Mary Barclay*. The College-Level Examination Program (CLEP) allows students to potentially earn college credit for subject material already mastered. This session serves to introduce faculty to how CLEP works, how students can use it to test out of general education requirements, and how it can be financially and educationally beneficial to students as they start college. □ BF ♦ CEU Ⓞ 19-10-02

CHRISTIAN VERSUS SECULAR EDUCATION. (GEN) *Tyler Trometer*. Students and parents know there is a difference between Christian and public schools. However, most of those students and parents don’t understand the most important

differences between secular and Christian education. This session will help you demonstrate the distinctive emphasis and value of Christian education. □ WPL ♦ CEU Ⓞ 19-10-03

HOW CAN I HELP MY STUDENTS BE BETTER WRITERS? (MS, HS) *Shawntel Chisholm*. This session focuses primarily on using mentor texts and writer’s workshop to teach students how to work through the parts of the writing process. In addition, ideas for integrating writing into literature instruction, including quickwrite, writing to source, and reflective writing, are offered. □ SA ♦ CEU Ⓞ 19-10-04

HOW TO USE THE SCHOOL CLASSROOM TO ENCOURAGE STUDENTS, BOTH CHILDREN AND YOUTH, TO SERVE THE LORD – INCLUDING MISSIONS. (EL, SEC) *Donald Kilmer*. This subject matter should not be left to church services or chapel as it is an essential part of the curricular priorities for every Christian school classroom. □ SC/D ♦ CEU Ⓞ 19-10-05



Are Injuries Hurting Your School's Budget?

GET A *FREE* CUSTOMIZED QUOTE FOR
SCHOOL ACCIDENT INSURANCE. VISIT:
STUDENTACCIDENT.NET/QUOTE

Contact: Cal Adams
Phone: 434.444.4470

Student
Accident 

IMPORTANT FACTORS THAT IMPACT YOUR SCHOOL'S ENROLLMENT. (PAS, ADM) *Dr. Hubert Hartzler.* During periods of economic decline, some Christian schools grew while others declined. How can a Christian school maintain a strong enrollment, even during hard times? This workshop identifies and explains several important factors. □ SB ♦ CEU ☉ 19-10-06

PROVIDING GUIDANCE SERVICES WHEN YOU DON'T HAVE A GUIDANCE COUNSELOR. (ADM) *Dr. Brian Carruthers.* Most Christian schools do not have the finances to employ a guidance counselor, and yet someone needs to attend to the myriad of guidance issues in the school. Most often, this becomes another responsibility for the busy administrator. This workshop outlines what is important and

how to fit it into an already busy schedule. □ COVE ♦ CEU ☉ 19-10-07

RESOURCES, RESOURCES, RESOURCES. (SEC) *Pam Litzenberger.* Where can I find "stuff" to make my class learn more effectively? If you are willing to put in the work and step "out of yourself," you can make your math class learn more and, most importantly, your students will understand the concept that you have taught them. □ TER ♦ CEU ☉ 19-10-08

THE PLYMOUTH COLONISTS – THEIR DEBT, THEIR MONOPOLY, AND THEIR TRADE WITH THE INDIANS. (SEC) *Dr. Roger Bradley.* A tale of early America which illustrates that a monopoly requires defending and that defending a monopoly can be very costly. □ RF ♦ CEU ☉ 19-10-09

Workshop 11

Friday: 12:50—1:40 p.m.

EMERGENCIES AND LITTLE PEOPLE. (EC, LEL) *Ian Thompson.* Being adults, when it comes to emergency planning, our default pattern of thinking keys into planning for adults. We shall discuss how every adult responsible for young children needs to reprogram himself to what we know about emergencies as applied to this very susceptible population. Protecting the weakest among us is our responsibility. We must be prepared on their behalf. □ SB ♦ CEU ☉ 19-11-01

IDEAS AND ACTIVITIES TO MAKE YOUR SECONDARY WORLD LANGUAGE CLASSROOM MORE EXCITING. (MS, HS) *Ann Carruthers.* Are your students losing interest in learning a new language? Are they just enduring verb conjugations? Are your classroom games and activities losing their appeal? Join me for a list of fun activities, apps, and ideas that will add excitement to your classroom, engage your students, and make language learning fun. □ RF ♦ CEU ☉ 19-11-02

MAKING MUSIC MAGICAL (INSTRUMENTAL MUSIC). (EL, SEC) *Janet Tschida.* "What is taking away from the magic of this piece?" Enable your student to go beyond the notes and rhythms by purposefully teaching universal principles of musicianship. □ BF ♦ CEU ☉ 19-11-03

MINORITY INTEGRATION IN THE CHRISTIAN SCHOOL. (GEN) *Aimee Stiles.* Explore how to effectively minister to minority families within your school community by being confident in God's calling, by showing compassion, and by practicing consistency. □ TER ♦ CEU ☉ 19-11-04

PROS, CONS, AND TIPS FOR USING INDIVIDUALIZED CURRICULUM. (ADM) *Tim Anger.* Individualized self-paced curriculum has been around for fifty years now. Can Christian schools use it for their core curriculum? Or to supple-

ment? We will discuss effective ways to use this approach in a variety of settings. □ WPL ♦ CEU ☉ 19-11-05

RUNNING RECORDS: ASSESSING AND IMPROVING THE READING SKILLS OF YOUR STUDENTS. (EL) *Dana Davis.* Running records are a fantastic assessment tool that can be used by classroom teachers to pinpoint the reading strengths and weaknesses of each student. Learn to create running record assessments that can be used to improve the reading skills of each child in your classroom. □ SC/D ♦ CEU ☉ 19-11-06

STANDING IN THE GAP: LEGAL UPDATES ON PENNSYLVANIA'S CHILD ABUSE PREVENTION LAWS. (PAS, ADM) *Michael Clater.* Questions continue to come to the KCEA office, so we shall review the law as applies to schools, principals, and teachers. The session will include time for Q & A. □ COVE ♦ CEU ☉ 19-11-07

TEACHING ACADEMIC WRITING: MAKING THE "IMPOSSIBLE" POSSIBLE. (SEC) *Cindy Quinlan.* How do you eat an elephant? One bite at a time. How do you complete a composition? One step at a time. Teach your students to be competent, confident writers by breaking each writing assignment down into clear steps that every student can follow. In this session, we will examine a variety of English writing assignments, showing how the teacher's use of steps, patterns, and examples supplies the students with the necessary know-how to write well. □ SA ♦ CEU ☉ 19-11-08

TEACHING CHARACTER. (GEN, ADM, PAS) *Eric Bryant.* This workshop will examine principles and techniques for teaching character in our students. □ CH ♦ CEU ☉ 19-11-09

REMINDERS

Please turn in your CEU and Conference Evaluation forms at KCEA's Registration Desk before you leave!

Did you know that KCEA has a Staff Certification Program? Contact the KCEA Office for more information on how this program can benefit your school and staff!



The Measure of Our Work

Successful graduates reflect the efforts of their Christian teachers throughout their adult lives. Daily, you're helping them build a biblical worldview and understand their studies, their passions, and God's call for them to represent Him in their lives. BJU Press supports those efforts by connecting faith, life, and work in every textbook.

Working With You.

www.bjupress.com



© 2019 BJU Press. All Rights Reserved.

PENSACOLA CHRISTIAN COLLEGE®

Where Your Students Are

EMPOWERED TO INFLUENCE THE WORLD FOR CHRIST



59 programs of study • Christ-centered campus • Opportunities to serve

Visit Our Booth to Find Out More & Get Your Free Gift!

**LIFE INSURANCE, CANCER PLANS,
BURIAL INSURANCE, HOSPITAL PLANS.
MEDICARE & MEDICAID,
HEALTH INSURANCE MARKETPLACE.
403(B) OR IRA,
NON-QUALIFIED OR 401(K).
HOME & AUTO, CYCLE & RV,
PERSONAL & COMMERCIAL LIABILITY,
DISABILITY, LONG TERM CARE,
TRAVEL INSURANCE FOR EVERYWHERE!
WE'RE A ONE-STOP SHOP
AND WE'RE HERE TO HELP...
CALL US NOW & PROTECT YOURSELF!**



**TOLL FREE:
800-355-3381**

*It doesn't matter if you need MORE insurance, less insurance, or
more affordable insurance...*

One call is all it takes to get the ball rolling!

COURTER FINANCIAL SERVICES, LLC

478 JACKSONVILLE RD | BELLEFONTE, PA 16823

WWW.COURTERFINANCIAL.COM | JUSTIN@COURTERFINANCIAL.COM | BOB@COURTERFINANCIAL.COM

"Follow Us": To Build Up or to Tear Down?

"He that gives good advice, builds with one hand; he that gives good counsel and example, builds with both; but he that gives good admonition and bad example, builds with one hand and pulls down with the other."

— Francis Bacon

13 Go to now, ye that say, To day or to morrow we will go into such a city, and continue there a year, and buy and sell, and get gain:

14 Whereas ye know not what shall be on the morrow. For what is your life? It is even a vapour, that appeareth for a little time, and then vanisheth away.

15 For that ye ought to say, If the Lord will, we shall live, and do this, or that.

16 But now ye rejoyce in your boastings: all such rejoicing is evil.

17 Therefore to him that knoweth to do good, and doeth it not, to him it is sin. —James 4:13-17

WANT TO SAVE 70-80% ON YOUR LIGHTING COST???

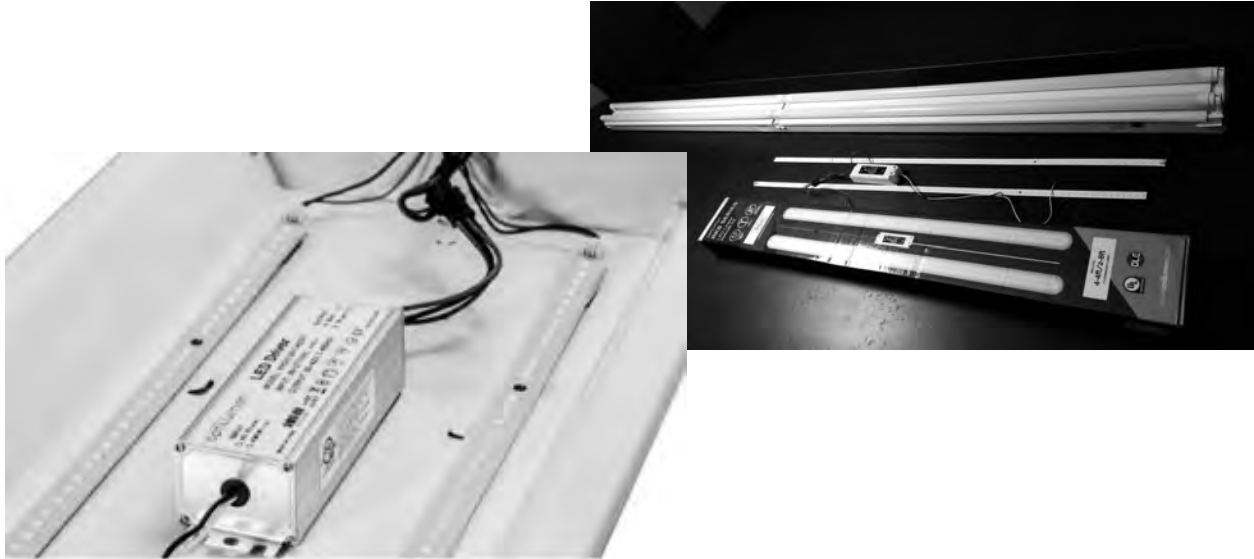

3 simple reasons why you should **check out LED Solutions** for fluorescent, gym, and parking lot fixtures:

1. LED lights provide you a better quality of light and will save you between 70% & 80% of your energy cost \$\$\$
2. Our lights are rated for 200,000 hours. That's more than 22 years of continuous use! No more maintenance!!!
3. Our lights are affordable and easy to install!

Ask about our

NO MONEY DOWN & NO MONEY OUT-OF-POCKET program and special **CONFERENCE PRICING!**

Get all the details from **LED Solutions** at our booth in the exhibit hall and see the difference in lights!

LED Solutions — An independent manufacturing representative for Optilumen products.

www.optilumen.com

LED Solutions LLC, PO Box 266, Elizabethville, PA 17023

Scott B. Kimmel, President

skimmel.ledsolutions@gmail.com



MID-DAY GENERAL ASSEMBLY

Friday: 2:00 p.m.
 Statesmen Hall
 CEU
 19-A-02

Education Address

Dr. Roger Bradley

“Confessions of a Reluctant Teacher: A Personal Testimony”

A personal testimony concerning God’s call to a ministry of Christian education and the struggle to respond.

Main Address

Dr. Alton Beal

“More Than an Educator”

When teachers and administrators understand their role in the discipleship process, God is glorified.

Workshop 12

Friday: 3:55—4:45 p.m.

BEYOND ACADEMICS: PREPARING PARENTS AND STUDENTS FOR THE REALITIES OF COLLEGE.

(GEN) *Dr. Mary Barclay.* Much attention is placed on getting students academically ready for college, and rightly so. However, academics are only one piece of the puzzle. This workshop will discuss some of the practical skills students must possess to make the transition to college as painless as possible and why those skills are so important. We will also discuss some realities for which parents need to be prepared when their children enter college, particularly FERPA. BF CEU 19-12-01

BY THE WAY~ LET’S TALK! (GEN) *Joy Budensiek.* Research by Dr. Jeff Myers of Summit Ministries found that 19 out of 20 Christian parents do not talk to their children about God and spiritual truth as they go about their daily living. That horrible statistic can change one family at a time! Let’s take advantage of every opportunity to share our faith with those who are coming behind us. This interactive session will provide ideas, material, and methods to encourage both classroom and “around the supper table” discussions. (A repeat of Workshop 2.) WPL CEU 19-12-02

COULD YOU BE SUBJECT TO MINISTRY-THREATENING ACCUSATIONS? CAN YOU REDUCE THE PROSPECT OF AN ACCUSATION? (GEN) *Ian Thompson.* Accusations can come from a variety of individuals and be related to a wide range of alleged conduct. Even if totally unfounded, accusations bring damage, even crippling damage at times. In this session, we will offer practical but proven ways to reduce the prospect of facing an accusation in one’s ministry as pastor, principal, teacher, or office staffer. (A repeat of Workshop 1.) EH CEU 19-12-03

CULTURES, CHRISTIANITY, AND CONFLICTS. (GEN) *Donald Kilmer.* As a missionary to South Africa, I faced, and continue to face, differences in cultures. But this is not new as I grew up in rural Lancaster County, PA, and went to college in a metropolitan city. In this session I will highlight cultural differ-

ences I have experienced and how I continue to endeavor to improve my effectiveness as I encounter them. (A repeat from Workshop 8.) CH CEU 19-06-04

DISCIPLINE VERSUS PUNISHMENT: A BIBLICAL PERSPECTIVE. (GEN) *Dr. Hubert Hartzler.* Do you discipline or punish your students when they misbehave? This workshop distinguishes the difference and gives practical help to teachers who desire to handle discipline problems from a biblical perspective. A/B/C/D CEU 19-12-05

HONORING GOD IN MATHEMATICS. (EL, JH) *Dee Long.* Where did mathematics come from? Why does it consistently work across time and culture? Let’s discuss thoughts to naturally and genuinely honor God in any age math class. (A repeat of Workshop 8.) WPR CEU 19-12-06

INCORPORATING A CHILD’S LEARNING STYLES. (EC, EL) *Sara Atwood.* Every student learns differently. Recognizing your student’s learning styles and incorporating them in your teaching can enhance learning. TER CEU 19-12-07

NAVIGATING HISTORY’S WATERS: HELPING STUDENTS MAKE THE MOST OF THEIR JOURNEY THROUGH HISTORY (7-12). SEC. *Cindy Quinlan.* With the right perspective and careful planning, each teacher can help his students skillfully navigate history’s waters and leave students with a vivid understanding of the people and events as well as the Biblical discernment necessary to apply history’s lessons. This session highlights essential teaching strategies and ideas that will challenge you to make each history class a fulfilling expedition. RF CEU 19-12-08

SPELLING S-U-C-C-E-S-S. (EL) *Brooke Greening.* How can we help our students have spelling success? Discover interactive techniques that teach and review spelling in appealing and beneficial ways. COVE CEU 19-12-09

ARE YOU REMEMBERING...

...to fill out your Conference Evaluation form? Leave it at KCEA’s Registration Desk before you leave.



Curriculum Lesson Plans

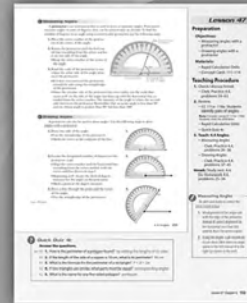

Teacher Editions

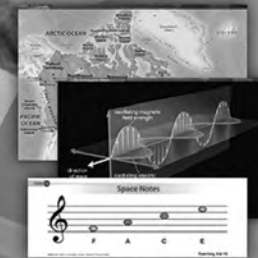

Digital Teaching Aids

Abeka Has You Covered

- Faster prep with lesson plans & teaching aids
- Easier grading with answer & solution keys
- Free support with professional development
- And, most importantly, a firm foundation



Biblical Worldview ▪ Research & Development ▪ Proven Philosophy ▪ Critical Thinking

Exhibitors and Advertisers

KCEA invites several hundred businesses and ministries to be part of the Conference.

We appreciate each who has chosen to be with us.

Exhibitors and advertisers have paid a fee to be represented. By doing so, they are supporting this Conference and Christian education.

Be sure to give your support to the exhibitors.

- Visit each of the exhibit displays.*
- Greet the men and women who are giving of their time to serve you.*
- Ask yourself, "How can this company's product or service benefit my school and me personally?"*
- Smile and thank them for coming.*
- Invite them to come back again.*
- Save the advertising pages for future reference. You never know when you might need the information.*

Abeka

P.O. Box 19100
Pensacola, FL 32523-9100
(877) 223-5226
Web: abeka.com
Email: information@abeka.com
Product: Christian Textbooks

See their ads on Pages 17 & 30.

Ambassador Baptist College

P.O. Box 158
Lattimore, NC 28089
(704) 434-0303
Web: ambassadors.edu
Email: info@ambassadors.edu
Product: Baptist College

See their ad on Page 7.

American Liberty Tours & Bill of Rights Bicentennial Committee

P.O. Box 912
Concordville, PA 19342
(610) 476-3482
Web: AmericanLibertyTours.com

Email: kohercj@verizon.net

Product: Patriotic, Historical, Tour Guiding, Publishing and Presentations

See their ad on Page 9.

Appalachian Bible College

161 College Drive
Mt. Hope, WV 25880
(304) 877-6428
Web: abc.edu
Email: admissions@abc.edu
Product: Bible College, Accredited, Camp

Bible Visuals International

P.O. Box 153
Akron, PA 17501
(717) 859-1131
Web: biblevisuals.org
Email: info@biblevisuals.org
Product: Visualized Bible lessons, mission stories, and songs for use in classrooms

Bob Jones University

1700 Wade Hampton Boulevard
Greenville, SC 29614
(864) 242-5100
Web: bju.edu
Email: recruit@bj.edu
Product: Promo Materials to Recruit Graduate Students

See their ad on Page 12.

Bob Jones University Press / Precept Marketing Group

1290 Heritage Drive
Elverson, PA 19520
(610) 286-2038
Web: preceptmarketing.com
Email: bjupinfo@bjupress.com
Product: BJU Press complete, Biblically-integrated preschool through Grade 12 curriculum

See their ad on Page 25.

By the Way Books

P.O. Box 1065
Hobe Sound, FL 33455
(772) 214-8966
Web: bythewayseries.com
Email: joybudensiek@aol.com
Product: Children's Books & Resources

Child Evangelism Fellowship of Eastern PA, Inc.

P.O. Box 4375
Harrisburg, PA 17112
(717) 652-7542
Web: cefepa.net
Email: cefepacarol@comcast.net
Product: Visualized Bible Lessons, Songs, Missionary Stories, Etc. for Elementary-Age Children

Courter Financial Services

478 Jacksonville Road
Bellefonte, PA 16823
(800) 355-3381
Web: courterfinancial.com
Email: bob@courterfinancial.com
Product: Insurance & Investment Services for Individuals

See their ad on Page 27.

Discovery Toys

991 Northfield Drive
Elizabethtown, PA 17022
(717) 201-4420
Web: discoverytoyslink.com/jlctoys
Email: jlcutting50@gmail.com
Product: Educational Children's Toy Products

Edge Camps

106 Page Road
Dublin, NH 03444
(603) 563-8505
Web: edgecamps.com
Email: edgecampdirector@yahoo.com
Product: Special Interest Camps

Educator Resources

85 Horseman Dr.
Lynchburg, VA 24502
(434) 444-4470
Email: cal@calvinadams.com
Product: Employee Services and Benefits

See their ad on Page 23.

Fairhaven Baptist College

86 East Oakhill Road
Chesterton, IN 46304
(219) 926-6636
Web: fairhavenbaptistcollege.org
Email: college@fairhavenbaptist.org
Product: Christian College

See their ad on Page 8.

GBC Fundraising

22 Whitney Drive
Milford, OH 45150-9781
(513) 400-8892
Web: gordonbernard.com
Email: kmenchen@gordonbernard.com
Product: Calendars & Fundraising

His Way and Sons

38 Walden Drive
Mountain Top, PA 18707
(570) 237-1504
Email: gmichaeltmsg@yahoo.com
Product: DaySpring Cards

James O. Bower Insurance, Inc.

P.O. Box 1310
Mechanicsburg, PA 17050
(717) 763-5668
Web: bowerins.com
Email: brad@bowerins.com
Product: Church Insurance

LED Solutions LLC

P.O. Box 266
Elizabethville, PA 17023
(717) 877-5669
Web: optilumen.com
Email: skimmel.ledsolutions@gmail.com
Product: LED retrofit lighting to replace fluorescent tubes and parking lot lights

See their ad on Page 28.

Maranatha Baptist University

745 W. Main Street
Watertown, WI 53094
(920) 206-2327
Web: mbu.edu
Email: jim.harrison@mbu.edu
Product: Christian College

Mar Cor Ministries

170 Wrenfield Way
Harleysville, PA 19438
(215) 584-8636
Web: marcorministries.org
Email: bobblum@me.com
Product: Kids' Ministry with Dog

See their ad on Page 18.

Mission: Imperative!

423 Orchid Circle
Lebanon, PA 17046
(717) 769-2002
Web: missionimperative.org
Email: carrie@missionimperative.org
Product: Creation DVDs and Books, Creation Seminars

Riverside Assessments

Riverside Assessments
One Pierce Place, Suite 900W
Itasca, IL 60143
(518) 355-7090
Web: hmhco.com
Email: Phillip.Contompasis@riversideinsights.com
Product: Testing & Measurements

MySchoolWorx

P.O. Box 1761
Tavares, FL 32778
(866) 990-2493
Email: tgreen@cloudgeex.com
Web: myschoolworx.com
Product: School management software

Pensacola Christian College

P.O. Box 18000
Pensacola, FL 32523
(800) 722-4636
Web: pcci.edu
Email: pccinfo@pcci.edu
Product: Christian College

See their ad on Page 26.

Quality Digital Office Solutions
1335 Strickler Rd
Mount Joy, PA 17552
(717) 293-1950
Web: QualityDOS.com
Email: joemc@qualitydos.com
Product: Sales, Service, Lease of Office Printers & Copiers. Managed Print Service
Thank You
For providing copier equipment for our use during this Conference.

Save U Money

45 Ben Hale Road
Gill, MA 01354
(413) 822-9502
Email: sumkarl@yahoo.com
Product: Books

Spruce Lake Outdoor School

5389 Route 447
Canadensis, PA 18325
(800) 822-7505
Web: sprucelake.org
Email: connie@sprucelake.org
Product: Outdoor Education Trip/Program for Schools

The Wilds

1000 Wilds Ridge Rd
Brevard, NC 28712
(828) 884-7811
Email: info@wilds.org
Web: www.wilds.org
Product: Music, Camping, Books

Tri-State Bible Camp

2 River Road
Montague, NJ 07827
(973) 293-3522
Web: tristatebiblecamp.org
Email: tsbc@tristatebiblecamp.org
Product: Christian Camp and Retreat Center for School and Church Retreats

Veritas Baptist College

181 US HWY 50 E, Suite 204
Greendale, IN 47025
(812) 221-1714
Email: johnedmonds@vbc.edu
Web: www.tristatebiblecamp.org
Product: Bible College

See their ad on Page 14.

Exhibitors registering after press time are not included above.

Thank you for coming. As you leave, we trust you will *LEAD* others even as you *FOLLOW* what you have learned these two days.

We will look for you next year:
September 24-25, 2020

Planning Your **THURSDAY** Schedule

All DoubleTree Luncheon Tickets are period specific to assure quality service.

ROOM	WORKSHOP 1 8:45 – 9:35	ASS'BL Y 9:45 – 11:30	WORKSHOP 2 11:45 – 12:35 (Suggested schedule) EXHIBITS 11:30 – 2:00 LUNCH B 12:35 – 1:45	WORKSHOP 3 12:50 – 1:40 (Suggested schedule) LUNCH A 11:30 – 12:40 EXHIBITS 11:30 – 2:00	WORKSHOP 4 2:00 – 2:50	WORKSHOP 5 3:15 – 4:05	WORKSHOP 6 4:30 – 5:20
STATESMEN A	X	Dr. Russ Shelley Donald Kilmer EDUCATION ADDRESS: MAIN ADDRESS:	Leading a Child to Christ <i>EC, EL</i> Dr. J. Davis	Understanding the Temperaments <i>EC, EL</i> Dr. J. Davis	Teaching Elementary School Bible <i>EL</i> Dr. Hartzler	What Is a Good Christian Teacher? <i>PAS, ADM, GEN</i> Bryant	Transform ... Teaching <i>GEN</i> D. Davis
STATESMEN B	X		Diagnosing and Treating Reading Diff's <i>EL</i> D. Davis	The Pillars of Evolution <i>GEN</i> Snavelly	Help for the Dyslexic and Severely Delayed <i>GEN</i> D. Davis	Go Beyond Head Knowledge <i>EL</i> Greening	Using Storytelling, Q & A, Dramatics <i>EL</i> Dr. Hartzler
STATESMEN C	X		X	What Is a Biblical Worldview? <i>GEN</i> Trometer	The State of Christian School Athletics <i>GEN</i> Eble	What Makes Education Christian? <i>GEN</i> Trometer	Cultures, Christianity <i>GEN</i> Kilmer
STATESMEN D	X			Books and Beyond <i>GEN</i> Clater	That's Not True! <i>GEN</i> Clater	The Fun Stuff of Preschool <i>EC</i> Crago	Preschool. Let's Begin <i>EC</i> Crago
MEZZANINE & CAFÉ	X	X	LUNCHEON A 11:30 – 12:40	LUNCHEON B 12:35 – 1:45	X	X	X
CHAPEL	X	X	Helping ... Develop Critical Thinking Skills <i>EL, MS</i> A. Carruthers	Winning Your Students in Arithmetic <i>EL</i> Greening	Individualizing Instruction in EL <i>EL</i> A. Carruthers	The Unseen Ministry... Teacher <i>GEN</i> Dr. Beal	Four Things Every Young Admin <i>PAS, ADM</i> Dr. Beal
TERRACE	Can You Use Technology <i>SEC</i> Litzenberger	X	Art of Explaining <i>GEN, ADM</i> Bryant	The Robber Barons <i>SEC</i> Dr. Bradley	Effective Reading Comprehension <i>MS, HS</i> Chisholm	Smoothing the Research-Paper <i>SEC</i> Quinlan	How to Teach Boys Differently <i>GEN</i> Anger
STARFISH COVE	The Liberal Arts <i>GEN</i> Dr. Bradley	X	Math Class Fundamentals <i>SEC</i> Quinlan	X	21st-Century Skills Movement <i>GEN, ADM</i> Bryant	Supporting Your Staff <i>ADM</i> Stiles	I Have No Idea What This Means! <i>PAS, ADM, OFF</i> J. A. Barclay
PALM COURT	Setup	Setup	Exhibits Open 11:30 a.m. – 6:00 p.m.				
BEN FRANKLIN	Could You Be Subject to ... Accusations? <i>GEN</i> Thompson	X	Menace or Motivator (Music) <i>EL, EC</i> Tschida	X	Prepare – Present – Practice (Music) <i>EL</i> Tschida	Direction ... Part I <i>SEC, GEN</i> Dr. Shelley	Direction ... Part II <i>SEC, GEN</i> Dr. Shelley
ROBERT FULTON	An Outward Expression <i>EL</i> Greening	X	Office Efficiency <i>OFF</i> Stiles	Common Issues in Teaching Math <i>SEC</i> Litzenberger	Overcoming Math Anxiety <i>SEC</i> Litzenberger	Connecting the Dots: Integrating Subjects <i>EL, SEC</i> Mary Barclay	A Unique Way: Enviro. Science <i>SEC</i> Edwards
EDWARD HAND	Music to Enhance Learning in the Content <i>EL, MS</i> Long	X	KCEA Board Meeting <i>PAS, ADM</i>	KCEA Board Meeting <i>PAS, ADM</i>	William Penn <i>GEN</i> Kocher	How Economics Can Help You Understand <i>HS, ADM</i> Dr. Bradley	Implementing Survival for First-Year Teacher <i>ADM</i> Dr. B. Carruthers
WILLIAM PENN (L)	When Butterflies Become Baboons <i>GEN</i> Tschida	X	By the Way- Let's Talk! <i>GEN</i> Budensiek	Introduction to Iowa and CogAT <i>GEN</i> Contompasis	Learning Important Truths <i>PAS, ADM, GEN</i> Thompson	Learning Important Truths <i>PAS, ADM, GEN</i> Thompson	Integrating a Foreign Language <i>EL</i> A. Carruthers
WILLIAM PENN (R)	Improving Your Admin. Communication Skills. <i>ADM</i> Dr. B. Carruthers	X	X	X	Are You an Instructional Leader? <i>ADM</i> Dr. B. Carruthers	Music to Enhance Learning <i>EL, MS</i> Long	A Hands-On ... Data Manager <i>ADM, GEN</i> Contompasis

Planning Your *FRIDAY* Schedule

All DoubleTree Luncheon Tickets are period specific to assure quality service.

ROOM	WORKSHOP 7 8:00 – 8:50	WORKSHOP 8 9:15 – 10:05	WORKSHOP 9 10:30 – 11:20	WORKSHOP 10 11:45 – 12:35 (Suggested schedule) LUNCH A 11:30–12:40 EXHIBITS 11:30–2:00	WORKSHOP 11 12:50 – 1:40 (Suggested schedule) LUNCH B 12:35–1:45 EXHIBITS 11:30–2:00	ASS'BL Y 2:00–3:45	WORKSHOP 12 3:55 – 4:45
STATESMEN A	The Power of Literature <i>SEC</i> Quinlan	Raising Rigor with the 2 Rs <i>SEC</i> Quinlan	I Have Suffered a Significant Trauma <i>GEN</i> D. Davis	How Can I Help - Better Writers <i>MS, HS</i> Chisholm	Teaching Academic Writing <i>SEC</i> Quinlan	EDUCATION ADDRESS: Dr. Roger Bradley Dr. Alton Beal MAIN ADDRESS:	Discipline Versus Punishment <i>GEN</i> Dr. Hartzler
STATESMEN B	Why Is Christian Education Fading <i>PAS</i> Dr. Beal	Lost Secrets of the Ancient Civilizations <i>GEN</i> Snaveley	I Am ... Electronic Screen Syndrome <i>GEN</i> Dr. Hartzler	Important Factors - Impact Enrollment <i>PAS, ADM</i> Dr. Hartzler	Emergencies and Little People <i>EC, LEL</i> Thompson		
STATESMEN C	Athletic Coaching <i>GEN</i> Stiles	Ideas...Spanish in the EL Classroom <i>EC, EL</i> A. Carruthers	I Have Been Confirmed to be a Gifted Student <i>GEN</i> Dr. M. Barclay	How to Use Classroom to Encourage <i>EL, SEC</i> Kilmer	Running Records: ...Reading Skills <i>EL</i> D. Davis		
STATESMEN D	Changing Our Mindset <i>EL, MS</i> Long	Honoring God in Mathematics <i>EL, MS</i> Long					
MEZZANINE & CAFÉ	X	X	X	LUNCH A 11:30–12:40	LUNCH B 12:35–1:45	X	X
CHAPEL	Leveling, Not Labeling <i>EL</i> D. Davis	Consider ... "Slow" Students. <i>EL, SEC</i> Kilmer	I Have ADHD <i>GEN</i> Atwood	Building Skills for Reading Comp <i>EL</i> Greening	Teaching Character <i>GEN, ADM, PAS</i> Bryant	X	Cultures, Christianity <i>GEN</i> Kilmer
TERRACE	Teaching and Learning <i>GEN</i> Dr. B. Carruthers	Strategies ... Biblical Worldview <i>GEN</i> Trometer	I Have Serious Food Allergy <i>OFF, GEN</i> Harris	Resources, Resources <i>SEC</i> Litzenberger	Minority Integration in the Christian School <i>GEN</i> Stiles	X	Incorporating ... Child's Learning Styles <i>EC, EL</i> Atwood
STAR-FISH COVE	QuickBooks...Part I <i>ADM, OFF, GEN</i> J. A. Barclay	QuickBooks...Part II <i>ADM, OFF, GEN</i> J. A. Barclay	X	Providing Guidance Services <i>ADM</i> Dr. B. Carruthers	Standing in the Gap (Child Abuse Laws) <i>PAS, ADM</i> Clater	X	Spelling S-U-C-C-E-S-S <i>EL</i> Greening
PALM CT	Exhibits 8:00 a.m. – 2:00 p.m.					Tear Down	
BEN FRANKLIN SCREEN	EL Level Chording for Sing-Alongs <i>EL, MS</i> Tschida	Improvisation (Music) <i>EL, GEN</i> Tschida	I Am an Adoptee <i>GEN</i> Budensiek	But I Know This Already <i>HS, ADM</i> Dr. M. Barclay	Making Music Magical <i>EL, SEC</i> Tschida	X	Beyond Acad...Prep for College <i>GEN</i> Dr. M. Barclay
ROBERT FULTON SCREEN	Are You Preparing Your Students <i>PAS, ADM, GEN</i> Thompson	Managing ... Process of Disenrolling <i>PAS, ADM</i> Thompson	I Am a Racial Minority <i>GEN</i> Stiles	The Plymouth Colonists <i>SEC</i> Dr. Bradley	Ideas ... World Language <i>MS, HS</i> A. Carruthers	X	Navigating History's Waters <i>GEN</i> Quinlan
EDWARD HAND	Essentials of the HS Economics Course <i>HS, ADM</i> Dr. Bradley	Not Your Parents' Copy Machine <i>GEN</i> Kyocera	X	X	X	X	Could You Be Subject to ...Accusations? <i>GEN</i> Thompson
WILLIAM PENN (L)	Critical Thinking and Pedagogy <i>GEN, ADM</i> Bryant	Current ... Paradigms <i>GEN, ADM, PAS</i> Bryant	X	Christian Versus Secular Education <i>GEN</i> Trometer	Pros, Cons... Indiv. Curriculum <i>ADM</i> Anger	X	By the Way-Let's Talk! <i>GEN</i> Budensiek
WILLIAM PENN (R)	Introduction to Iowa and CogAT <i>GEN</i> Contompasis	A Hands-On ... Data Manager <i>ADM, GEN</i> Contompasis	X	X	X	X	Honoring God in Mathematics <i>EL, MS</i> Long

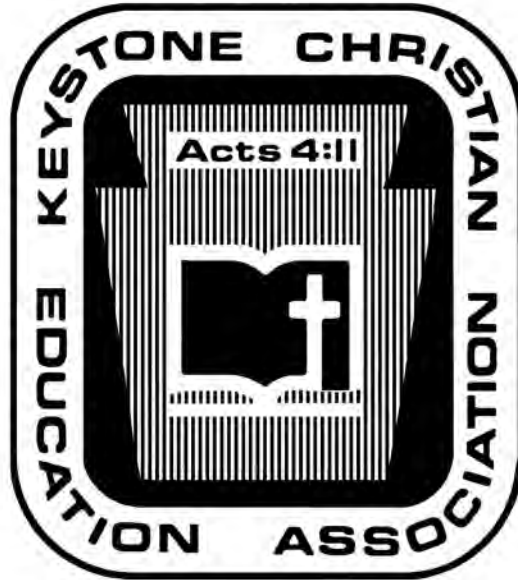

Keystone Christian Education Association

6101 Bell Road
Harrisburg, PA 17111-3817
Phone: (717) 564-1164
Fax: (717) 564-1163
Email: tclater@kcea.com
Web: www.kcea.com

Acknowledgements:

Logo Design – Kenneth Gore, Centre Hall, PA • kgraphixpsu@gmail.com

Banner – HalfPriceBanners.com • (866) 527-1363 • www.halfpricebanners.com

Printing – Fortney Printing, Bressler (Harrisburg), PA • (717) 939-6422 • fortneyptg@aol.com

Conference Copier Services – Quality Digital Office Solutions, Mount Joy, PA • (717) 293-1950 • joemc@qualitydos.com

Document Envelope – Roberts Event Services, Marietta, PA • (717) 917-2724 • www.robertseventserv.com